

Tile Replacement Conduit Penetration Flashing

QMCPT-F | QMCPT-W | QMCPT-S



Quick Mount PV®
RESPECT THE ROOF

Installation Instructions

Installation Tools Required: tape measure, drill with paddle bit, caulking gun and sealant compatible with roofing material, hook blade, hammer, roofing nails, whisk broom, roofing bar.



1. Locate and remove the tile that will be replaced by the tile replacement flashing. Remove tile to the left of and above the penetration location. Place the replacement flashing in its final location and, using the cone of the replacement flashing as a guide, mark the location of the conduit hole.

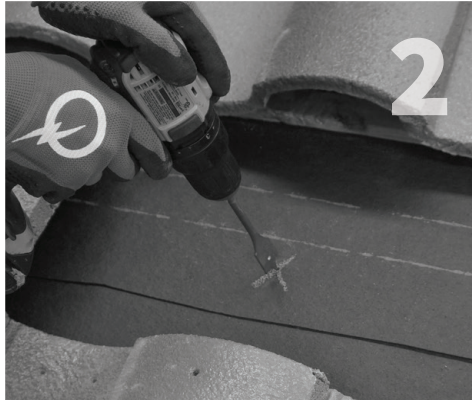

2. Drill your conduit hole next so you can secure the conduit below the roof surface to a rafter or blocking. For 1/2" conduit, drill a 7/8" hole; for 3/4" conduit, drill a 1" hole; for 1" conduit, drill a 1 1/4" hole.

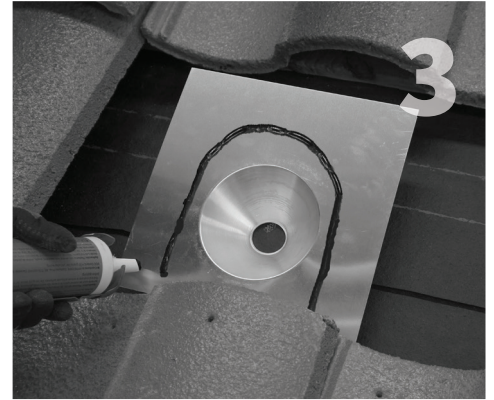

3. Apply sealant compatible with the roofing material on the underside of the subflashing in and upside down U. For waterproofing with the 3-Course Method you may turn the flashing 180 degrees to avoid materials interfering with the batten.

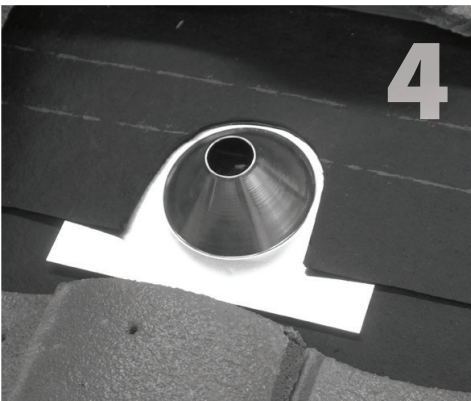

4. Clear away any dust and debris and install subflashing. Waterproof at underlayment level according to roofing manufacturer instructions and Tile Roofing Institute Guidelines.

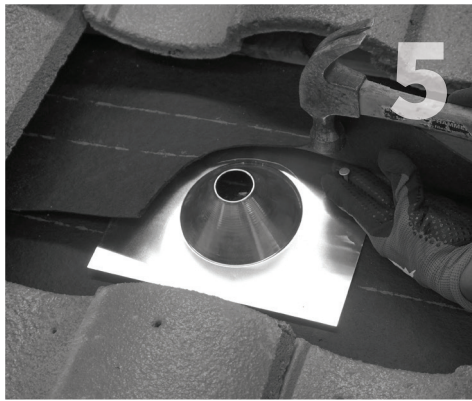

5. Under the top layer of felt, secure the subflashing with 2 roofing nails at the top corner of the subflashing. Apply sealant over the nail heads.



6. Cut the EPDM collar to appropriate conduit size.

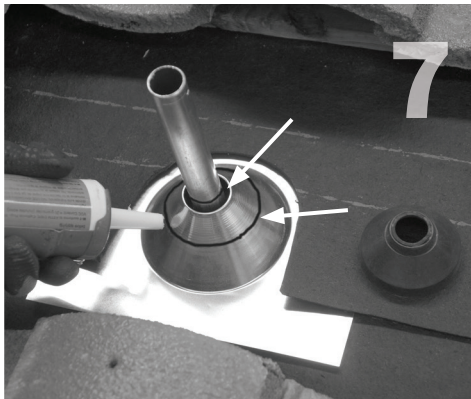

7. Apply a bead of sealant compatible with both the roofing material and EPDM rubber to both the flashing and the conduit in the location of the EPDM collar's final position.

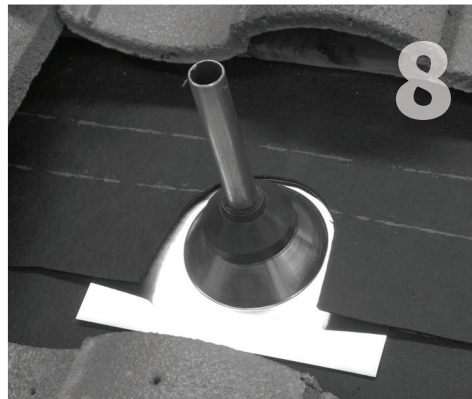

8. Slide the collar over the conduit all the way down to the flashing.



9. Place the tile replacement flashing over the conduit, allowing flashing to interlock with surrounding tiles properly. Replace surrounding tiles.

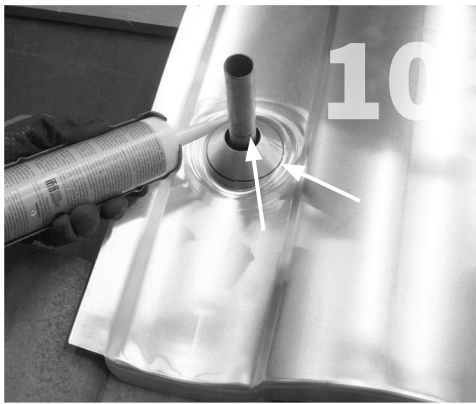

Apply a bead of sealant compatible with the EPDM rubber to both the flashing and the conduit in the location of the EPDM collar's final position.

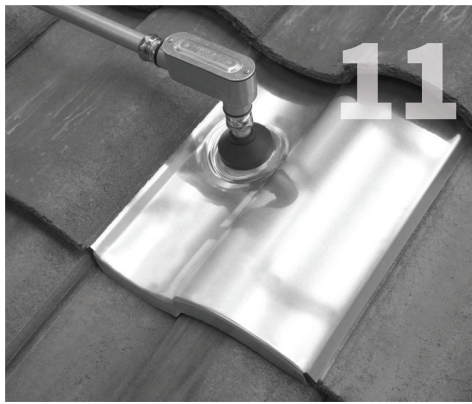

Slide the appropriately cut collar over the conduit all the way down to the flashing.

Your tile replacement conduit penetration flashing is now complete and ready for additional electrical work. Be sure to secure conduit to rafters or wood blocking below the roof surface per local building codes and NEC code requirements.

All roofing manufacturers' written instructions must also be followed. Please consult the roof manufacturer's specs and instructions prior to installing on the roof.

Additional tips and information for installing mounts:

- You can also use measurements to find the location of the conduit hole. Measure $8\frac{3}{4}$ " up from the bottom of the row of tiles the flashing will be placed in. Then measure horizontally from the edge of the tile to the left of the flashing placement. For flat tiles measure $3\frac{3}{4}$ ", for w-shaped tiles measure $5\frac{1}{2}$ ", and for s-shaped tiles measure $2\frac{1}{2}$ ". Mark the intersection of the two measurements for drilling.
- Install blocking and secure conduit before running wires through the conduit in the Tile Replacement Penetration Flashing.
- Waterproofing the subflashing of the Tile Replacement Penetration Flashing at the same time as the roof mounts are being waterproofed can save some time.

WARNING: Quick Mount PV products are NOT designed and should NOT be used to anchor fall protection equipment.

ITEM NO.	DESCRIPTION	QTY.
1	SUB-FLASHING, CONE, 9"X9".020"/.032", 3003 AL, MILL	1
2	COUNTER FLASHING, CONDUIT, 1/2", 3/4", 1", EPDM RUBBER	2
3	FLASHING, REPLACEMENT TILE, FLAT, 1" CONE, ALUMINUM, MILL	1

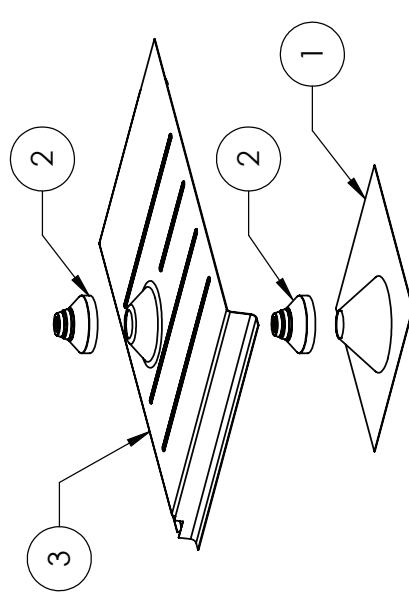
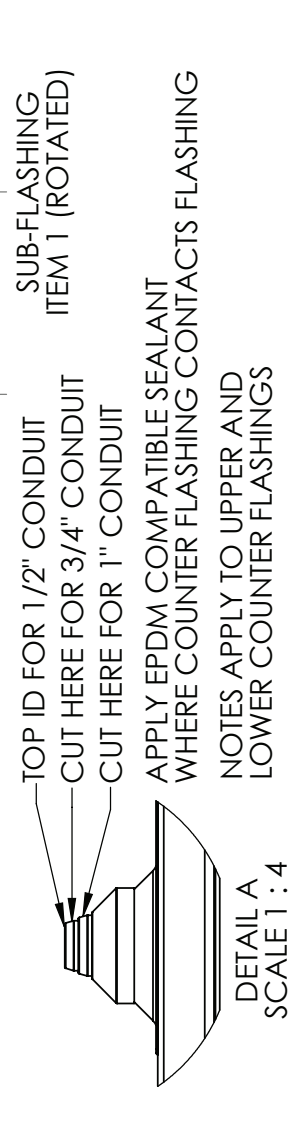
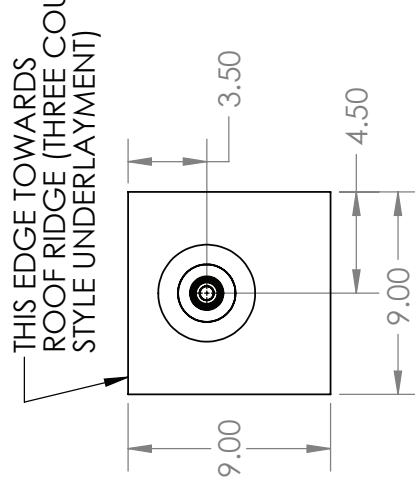
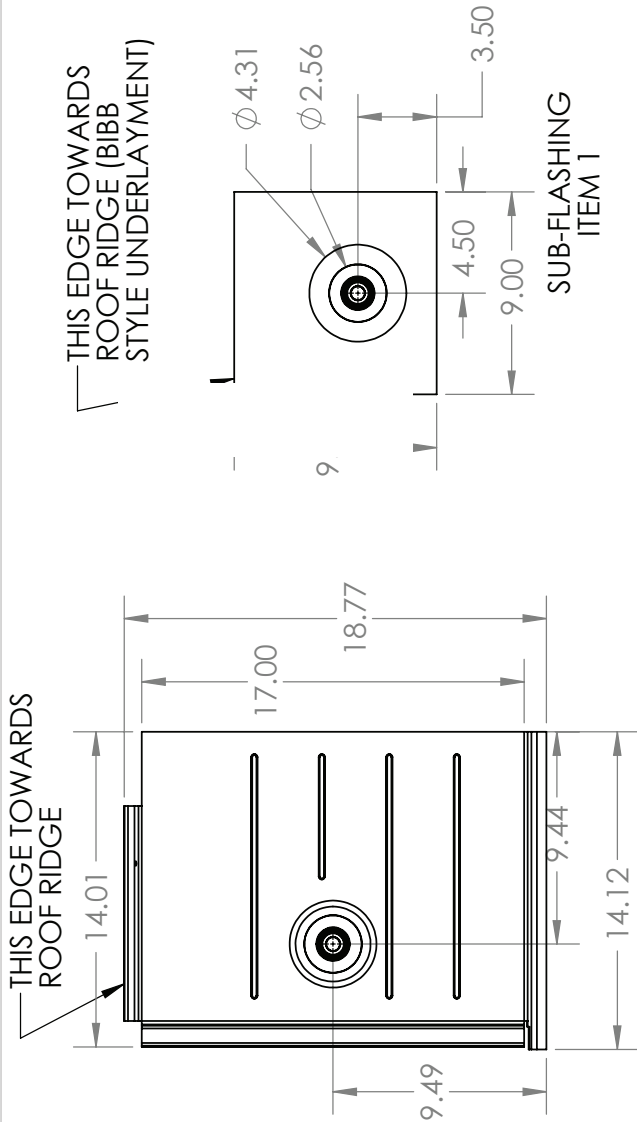

NOTES:

1. AVAILABLE IN MILL FINISH, AND BLACK FINISH
2. FLASHINGS MAY BE SPUN, OR PRESSED
3. ITEM 3 MATERIAL THICKNESS: .032"
4. ITEM 1 MATERIAL THICKNESS: .020" SPUN, .032" PRESSED

Quick Mount PV

TITLE: **QMCPT-F: CONDUIT PENETRATION FLASHING, TILE REPLACEMENT, FLAT TILE**

UNLESS OTHERWISE SPECIFIED:	SIZE	DRAWN BY:	AAP	REV
DIMENSIONS ARE IN INCHES	A	DATE:	6/13/2019	2
TOLERANCES:				
FRACTIONAL ± 1/8				
TWO PLACE DECIMAL ±.19				
THREE PLACE DECIMAL ±.094				

SCALE: 1:8 WEIGHT: 1.22 SHEET 1 OF 1

DO NOT SCALE DRAWING

PROPRIETARY AND CONFIDENTIAL
THE INFORMATION CONTAINED IN THIS DRAWING IS THE SOLE PROPERTY OF QUICK MOUNT PV. ANY REPRODUCTION IN PART OR AS A WHOLE WITHOUT THE WRITTEN PERMISSION OF QUICK MOUNT PV IS PROHIBITED. COPYRIGHT © 2019 QUICK MOUNT PV

ITEM NO.	DESCRIPTION	QTY.
1	SUB-FLASHING, CONE, 9"X9"X.020"/.032", 3003 AL, MILL	1
2	COUNTER FLASHING, CONDUIT, 1/2", 3/4", 1", EPDM RUBBER	2
3	FLASHING, REPLACEMENT TILE, W-TILE, .625" CONE, ALUMINUM, MILL	1

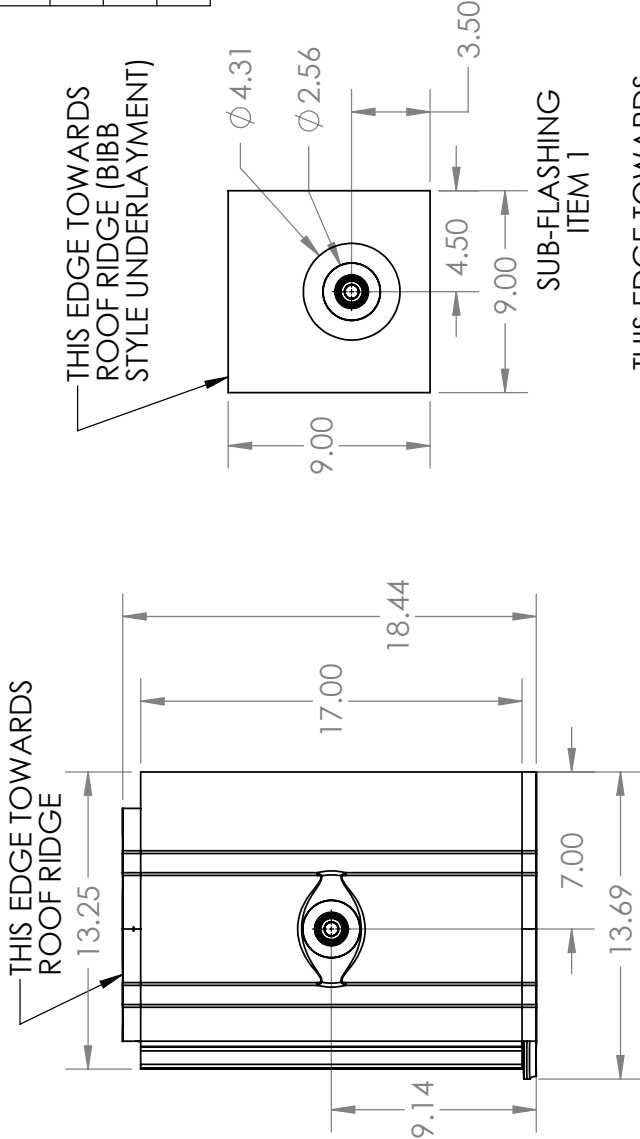

THIS EDGE TOWARDS ROOF RIDGE (THREE COURSE STYLE UNDERLAYMENT)

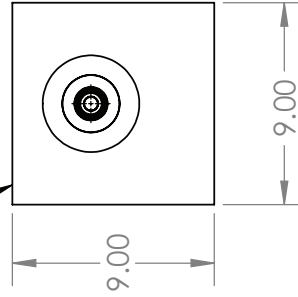

SUB-FLASHING ITEM 1 (ROTATED)



NOTES:

1. AVAILABLE IN MILL FINISH, AND BLACK FINISH
2. FLASHINGS MAY BE SPUN, OR PRESSED
3. ITEM 3 MATERIAL THICKNESS: .032"
4. ITEM 1 MATERIAL THICKNESS: .020" SPUN, .032" PRESSED

THIS EDGE TOWARDS ROOF RIDGE

TOP ID FOR 1/2" CONDUIT
CUT HERE FOR 3/4" CONDUIT
CUT HERE FOR 1" CONDUIT

APPLY EPDM COMPATIBLE SEALANT WHERE COUNTER FLASHING CONTACTS FLASHING
NOTES APPLY TO UPPER AND LOWER COUNTER FLASHINGS

DETAIL A
SCALE 1 : 4

PROPRIETARY AND CONFIDENTIAL
THE INFORMATION CONTAINED IN THIS DRAWING IS THE SOLE PROPERTY OF QUICK MOUNT PV. ANY REPRODUCTION IN PART OR AS A WHOLE WITHOUT THE WRITTEN PERMISSION OF QUICK MOUNT PV IS PROHIBITED. COPYRIGHT © 2019 QUICK MOUNT PV

DO NOT SCALE DRAWING

Quick Mount PV

TITLE:

QMCPT-W: CONDUIT PENETRATION FLASHING, TILE REPLACEMENT, W-TILE

UNLESS OTHERWISE SPECIFIED:
DIMENSIONS ARE IN INCHES
TOLERANCES:
FRACTIONAL ± 1/8
TWO PLACE DECIMAL ±.19
THREE PLACE DECIMAL ±.094

SIZE	DRAWN BY:	AAP	REV
A	DATE:	6/13/2019	2
SCALE: 1:8	WEIGHT: 1.22	SHEET 1 OF 1	

ITEM NO.	DESCRIPTION	QTY.
1	SUB-FLASHING, CONE, 9"X9"X.020"/.032", 3003 AL, MILL	1
2	COUNTER FLASHING, CONDUIT, 1/2", 3/4", 1", EPDM RUBBER	2
3	FLASHING, REPLACEMENT TILE, S-TILE, .625" CONE, ALUMINUM, MILL	1

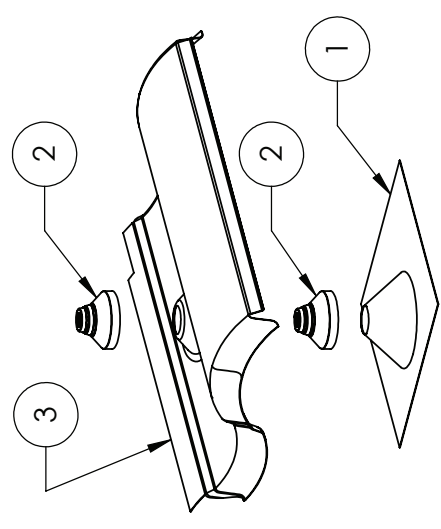
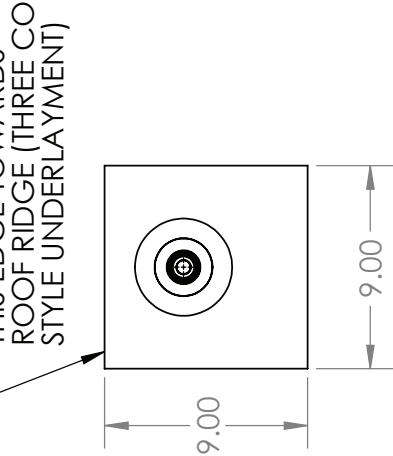
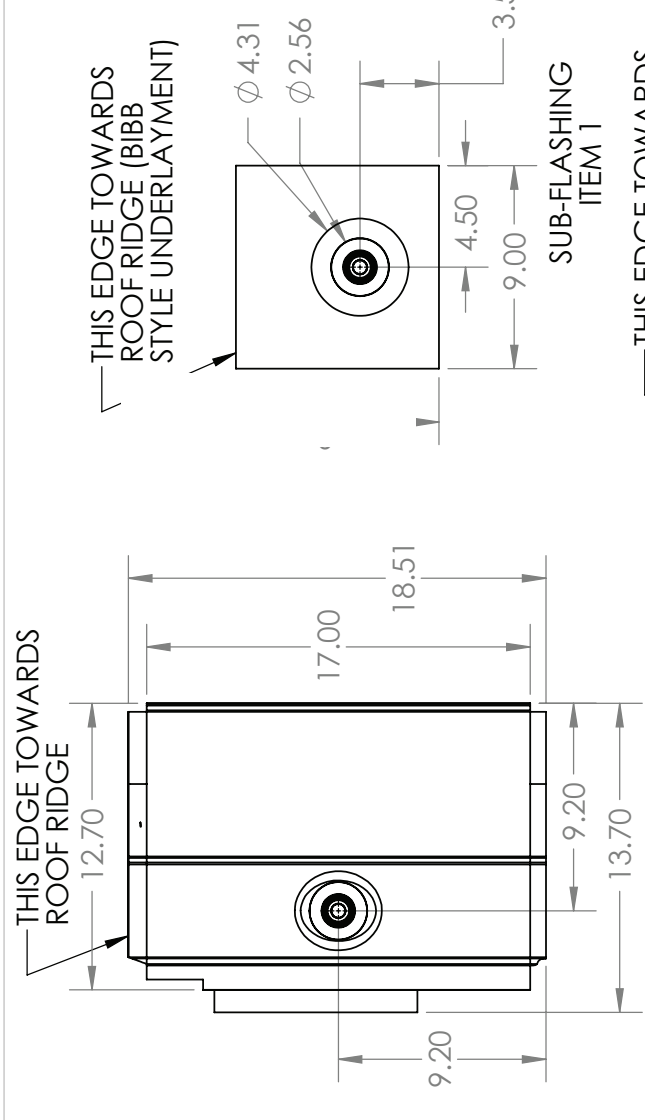

NOTES:

1. AVAILABLE IN MILL FINISH, AND BLACK FINISH
2. FLASHINGS MAY BE SPUN, OR PRESSED
3. ITEM 3 MATERIAL THICKNESS: .032"
4. ITEM 1 MATERIAL THICKNESS: .020" SPUN, .032" PRESSED



**DETAIL A
SCALE 1:4**

PROPRIETARY AND CONFIDENTIAL
THE INFORMATION CONTAINED IN THIS DRAWING IS THE SOLE PROPERTY OF QUICK MOUNT PV. ANY REPRODUCTION IN PART OR AS A WHOLE WITHOUT THE WRITTEN PERMISSION OF QUICK MOUNT PV IS PROHIBITED. **COPYRIGHT © 2019 QUICK MOUNT PV**

DO NOT SCALE DRAWING

Quick Mount PV

TITLE:
QMCPT-S: CONDUIT PENETRATION FLASHING, TILE REPLACEMENT, S-TILE

UNLESS OTHERWISE SPECIFIED: DIMENSIONS ARE IN INCHES TOLERANCES: FRACTIONAL ± 1/8 TWO PLACE DECIMAL ±.19 THREE PLACE DECIMAL ±.094	SIZE A	DRAWN BY: AAP	REV 2
SCALE: 1:8	DATE: 6/13/2019	WEIGHT: 1.16	SHEET 1 OF 1



925-478-8269 | www.quickmountpv.com | tech@quickmountpv.com
2700 Mitchell Dr. | Walnut Creek, CA 94598